





Safety notes

EN

Explanation of symbols

Symbol	Meaning
 WARNING	Refers to a potentially dangerous situation that may cause serious injury or death.
 CAUTION	Refers to a potentially dangerous situation that may cause slight or moderate injury or material damage.
	Refers to important information.
	Refers to correct usage.



WARNING

Risk of injury caused by flying fragments if used incorrectly or if worn / damaged pressing collars or adapters for pressing collar are used

- ▶ Only use the pressing collar and adapter for pressing collar if they are in perfect working order
- ▶ Take pressing collars and adapters for pressing collar displaying material cracks out of service immediately and do not continue to use them
- ▶ The maintenance intervals must be adhered to
- ▶ The pressing collar and adapter for pressing collar may only be used by a skilled person



Pressing collars and adapters for pressing collar are wearing parts. Frequent pressing will cause the material to become worn; advanced stages of wear will be indicated by cracks in the material. Pressing collars and adapters for pressing collar that display this kind of wear or are damaged in any other way may break, particularly if they are used incorrectly (e. g. tilting, incorrectly positioned pressing collar, corrective pressing, dirt between the pressing collar components or between the pressing collar and the fitting) or in a way that does not comply with their intended use.



WARNING

Danger of crushing by moving parts

- ▶ Do not hold any parts of your body or other objects in between the pressing collar, adapter for pressing collar and pressfitting
- ▶ Do not hold the adapter for pressing collar or pressing collar with your hands during the pressing sequence

Risk of material damage caused by incorrect handling

- ▶ Replace worn pressing collar and adapter for pressing collar
- ▶ Use the transport case for transport and storage; store the pressing collar and adapter for pressing collar in a dry room
- ▶ Have any damage inspected immediately by an authorized repair shop
- ▶ Observe the safety notes with respect to the cleaning and corrosion protection agents used

Intended use

Mapress pressing collars and adapters for pressing collar are used exclusively for professional pressing of Mapress pipes with Mapress fittings. Geberit recommends using Mapress pressing collars and adapters for pressing collar only in conjunction with the following pressing tools:

- Geberit pressing tools with the same compatibility as the pressing collar and adapter for pressing collar (indicated by compatibility marks **2**, **2XL** or **3**)
- Pressing tools from other manufacturers approved by Geberit for processing Mapress

Other pressing tools have not been tested by Geberit in terms of their suitability for the Mapress pressfitting system.

Structure

Mapress pressing collar up to \varnothing 66.7 mm

- 1 Sliding segments
- 2 Pressing contour
- 3 Locking lug
- 4 Pins with contact
- 5 Grooves
- 6 Joints
- 7 Shells
- 8 Locking pins with contact
- 9 Marks

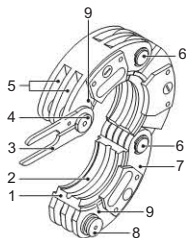

The appearance can vary depending on the size and design.

Mapress pressing collar \varnothing 76.1 - 108 mm

- 1 Sliding segments
- 2 Pressing contour
- 3 Locking lug
- 4 Pins with contact
- 5 Grooves
- 6 Joints
- 7 Shells
- 8 Locking pins with contact
- 9 Marks
- 10 Release lever (only with \varnothing 108 mm)
- 11 Centring plate

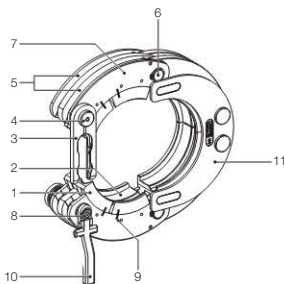

Mapress adapter for pressing collar

- 1 Jaw lever
- 2 Claw
- 3 Contacts
- 4 Jaw joints

The appearance can vary depending on the size and design.

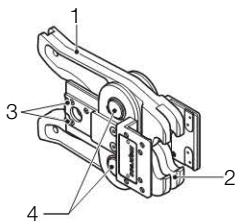

Commissioning

Inserting the adapter for pressing collar into the pressing tool

The procedure for inserting the adapter for pressing collar depends on the type of pressing tool and is therefore described in the operating instructions of the pressing tool.



Use pressing tool ACO 3 (EFP 3, AFP 3) only up to \varnothing 66.7 mm with adapter for pressing collar ZB 302!



WARNING

Risk of injury caused by flying fragments if used incorrectly or if worn / damaged pressing collars or adapters for pressing collar are used

- ▶ Do not tilt the pressing collar on the pressfitting
- ▶ Make sure the pressing collar is positioned correctly on the fitting bead
- ▶ Do not perform any corrective pressing
- ▶ Clean away any dirt, chips or the like between the pressing collar components and between the pressing collar and the fitting
- ▶ If the pressing collar and adapter for pressing collar have been used incorrectly, do not continue to use them and have them inspected by an authorized repair shop



Pressing collars and adapters for pressing collar are wearing parts. Frequent pressing will cause the material to become worn; advanced stages of wear will be indicated by cracks in the material. Pressing collars and adapters for pressing collar that display this kind of wear or are damaged in any other way may break, particularly if they are used incorrectly (e. g. tilting, incorrectly positioned pressing collar, corrective pressing, dirt between the pressing collar components or between the pressing collar and the fitting) or in a way that does not comply with their intended use.

Operation

EN

Pressing pressfitting up to \varnothing 88.9 mm

Orientation

Pressing with a pressing collar and adapter for pressing collar involves the following steps:

- Fit the pressing collar around the pressfitting
- Hook the adapter for pressing collar into the pressing collar
- Press the connection

The adapter for pressing collar must match the pressing collar used.

ø mm	Compatibility [2] / [2 XL]		Compatibility [3]	
	Adapter for pressing collar	Pressing tool	Adapter for pressing collar	Pressing tool
1"	-	-	ZB 302 (ZB 301)	ECO 301
35 42 54	ZB 201	EFP 2, ECO 201, ACO 201, MFP 2 (ECO 1, ACO 1, PFP 2, EFP 201, EFP 1, PWH 75)	ZB 302 (ZB 301)	ECO 301, ACO 3 (ECO 3, EFP 3, AFP 3)
66.7	-	-	ZB 302	ECO 301, ACO 3 (ECO 3, EFP 3, AFP 3)
76,1 88,9	ZB 221	ACO 202 XL	ZB 321	ECO 301 (ECO 3)
108	ZB 221 + ZB 222	ACO 202 XL	ZB 321 + ZB 322	ECO 301 (ECO 3)

Fitting the pressing collar around the pressfitting (up to \varnothing 88.9 mm)



CAUTION

Leaking connection due to failed pressing sequence

- ▶ Clean away any dirt, chips or the like between the pressing collar and the pressfitting
- ▶ Make sure the pressing collar is positioned correctly on the fitting bead

Damage to pipe due to faulty pressing collar that can no longer be released

- ▶ Make sure that the sliding segments can move and give
- ▶ Make sure that the sliding segments and shells can be aligned with one another
- ▶ Replace the pressing collar if the sliding segments and shells are not functioning



After 25 pressing operations in the pressing contour, spray the pressing collar with a small amount of BRUNOX®Turbo-Spray® or equivalent.

- 1** Ensure the diameter of the pressfitting matches the diameter of the pressing collar and that the adapter for pressing collar matches the pressing collar
- 2** To open the pressing collar, depress the locking pin and, at the same time, pull the pressing collar apart at the locking lug

3

Ensure that the sliding segments move freely and that the marks (1) on the sliding segments (2) and the shells (3) form a line

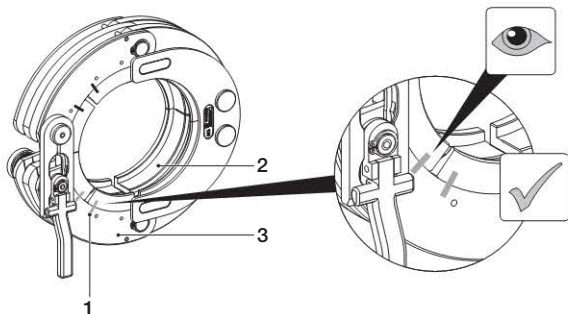

With pressing collar $\varnothing 76.1 - 108$ mm: The pressing collar is correctly positioned when the centring plate is pointing towards the pipe.

4

Fit the pressing collar around the pressfitting and ensure that the pressing contour of the pressing collar is positioned on the fitting bead

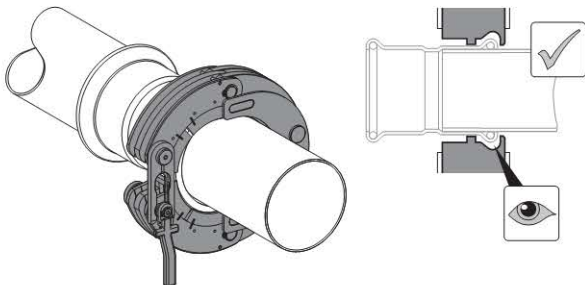

- 5 Slide the locking lug over the locking pin until it snaps into place and the pressing collar firmly surrounds the fitting
- 6 Turn the pressing collar into the pressing position
- 7 Make sure that the release lever and locking lug form a line

Hooking the adapter for pressing collar into the pressing collar (up to \varnothing 88.9 mm)

Prerequisites

Pressing collar is positioned.



WARNING

Risk of injury caused by flying fragments if adapter for pressing collar is used incorrectly

- ▶ Make sure that the claws of the adapter for pressing collar always completely embrace the pins of the pressing collar



Do not remove or twist the pressing collar after interrupting the pressing sequence.

1

To open the adapter for pressing collar, push both jaw levers together (1)

- 2** Guide the claws of the adapter for pressing collar into the grooves of the pressing collar (2) and hook them into the pins. Make sure that the claws completely embrace the pins (3)

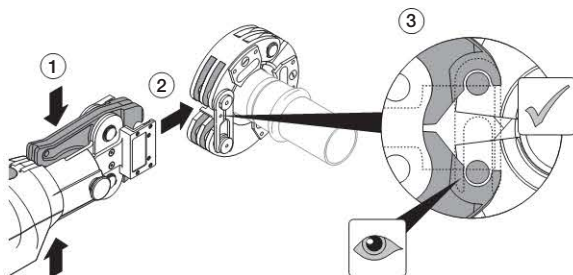

- 3** Release both jaw levers

Pressing the connection (up to \varnothing 88.9 mm)



CAUTION

Risk of injury caused by the pressing collar falling when released

- ▶ Hold pressing collar when releasing

- 1** Press the pressfitting; see operating instructions for the pressing tool
- 2** Open the adapter for pressing collar and remove it from the pressing collar

3

Open and remove the pressing collar



CAUTION

Leaky connection due to failed pressing sequence

- ▶ Ensure that the pressing collar is completely closed after the pressing sequence
- ▶ Have any pressing collars that have not closed completely as well as the adapter for pressing collar and the pressing tool inspected for damage by an authorized repair shop. Replace any connections that have not been pressed correctly (do not attempt corrective pressing)
- ▶ If there are any burrs on the pressfitting after the pressing sequence, have the pressing collar and the adapter for pressing collar inspected by an authorized repair shop

Pressing the pressfitting \varnothing 108 mm

Orientation

The pressing sequence consists of two steps:

- Preliminary pressing with adapter for pressing collar 221 / 321
- Final pressing with adapter for pressing collar 222 / 322

The position of the locking pin in the locking lug indicates the status of the pressing sequence:

- Position 1: Pressing collar is positioned
- Position 2: After preliminary pressing with adapter for pressing collar 221 / 321
- Position 3: After final pressing with adapter for pressing collar 222 / 322

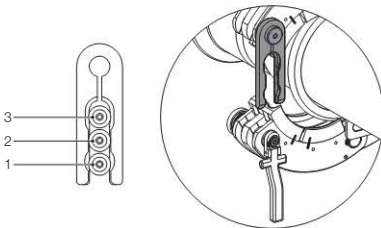

Fitting the pressing collar around the pressfitting (ø 108 mm)



CAUTION

Leaking connection due to failed pressing sequence

- ▶ Clean away any dirt, chips or the like between the pressing collar and the pressfitting
- ▶ Make sure the pressing collar is positioned correctly on the fitting bead

Damage to pipe due to faulty pressing collar that can no longer be released

- ▶ Make sure that the sliding segments can move and give
- ▶ Make sure that the sliding segments and shells can be aligned with one another
- ▶ Replace the pressing collar if the sliding segments and shells are not functioning



After 25 pressing operations in the pressing contour, spray the pressing collar with a small amount of BRUNOX®Turbo-Spray® or equivalent.

- 1** Ensure the diameter of the pressfitting matches the diameter of the pressing collar and that the adapter for pressing collar matches the pressing collar
- 2** To open the pressing collar, depress the locking pin and, at the same time, pull the pressing collar apart at the locking lug

- 3** Ensure that the sliding segments move freely and that the marks (1) on the sliding segments (2) and the shells (3) form a line

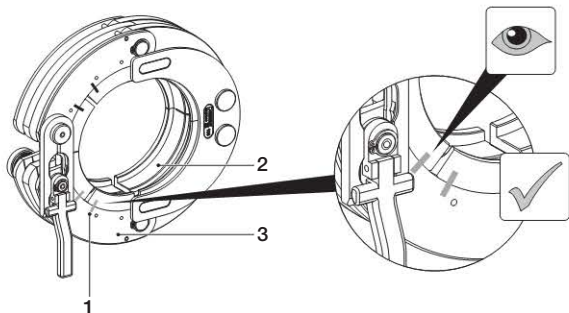

The pressing collar is correctly positioned when the centring plate is pointing towards the pipe.

- 4** Fit the pressing collar around the pressfitting and ensure that the pressing contour of the pressing collar is positioned on the fitting bead

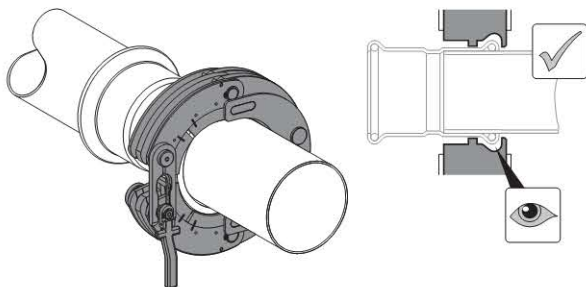

- 5 Slide the locking lug over the locking pin until it snaps into place (position 1) and the pressing collar firmly surrounds the fitting
- 6 Turn the pressing collar into the pressing position
- 7 Make sure that the release lever and locking lug form a line

Hooking the adapter for pressing collar ZB 221 / 321 into the pressing collar (ø 108 mm)

Prerequisites

Pressing collar is positioned. Locking pin is in position 1.



WARNING

Risk of injury caused by flying fragments if adapter for pressing collar is used incorrectly

- ▶ Make sure that the claws of the adapter for pressing collar always completely embrace the pins of the pressing collar



Repeat the pressing operation if a position of the locking pin is not reached during the pressing operation or the pressing sequence is interrupted. See also operating instructions of pressing tool.

- 1 To open the adapter for pressing collar, push both jaw levers together (1)

- 2** Guide the claws of the adapter for pressing collar into the grooves of the pressing collar (2) and hook them into the pins. Make sure that the claws completely embrace the pins (3)

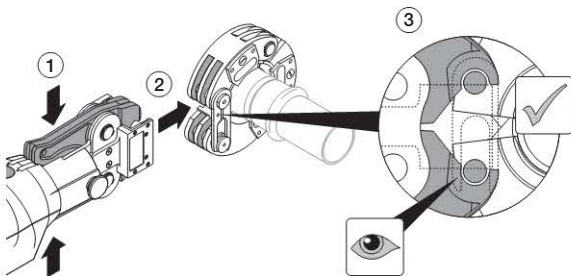

- 3** Release both jaw levers

Preliminary pressing with adapter for pressing collar ZB 221 / 321 (ø 108 mm)

- 1** Press the pressfitting; see operating instructions for pressing tool
- 2** Open the adapter for pressing collar and remove it from the pressing collar
- 3** Make sure that the locking pin is in position 2

i Result:
Preliminary pressing is complete.
The pressing collar can no longer be removed.
The process of establishing the connection is not completed until the final pressing has been carried out with adapter for pressing collar ZB 222 / 322.

Hooking the adapter for pressing collar ZB 222 / 322 into the pressing collar (ø 108 mm)

Prerequisites

Pressing collar is positioned. Locking pin is in position 2.



WARNING

Risk of injury caused by flying fragments if adapter for pressing collar is used incorrectly

- ▶ Make sure that the claws of the adapter for pressing collar always completely embrace the pins of the pressing collar



Repeat the pressing operation if a position of the locking pin is not reached during the pressing operation or the pressing sequence is interrupted. See also operating instructions of pressing tool.

1

To open the adapter for pressing collar, push both jaw levers together (1)

2

Guide the claws of the adapter for pressing collar into the grooves of the pressing collar (2) and hook them into the pins. Make sure that the claws completely embrace the pins (3)

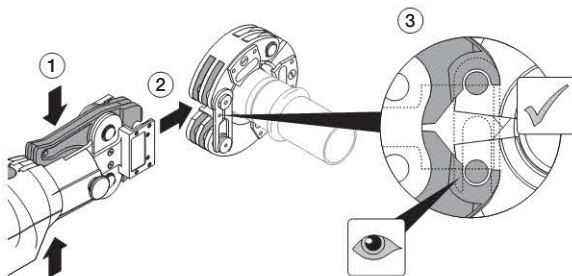

3

Release both jaw levers

Final pressing with adapter for pressing collar ZB 222 / 322 (ø 108 mm)



CAUTION

Risk of injury caused by the pressing collar falling when released

▶ Hold pressing collar when releasing

- 1 Press the pressfitting; see operating instructions for the pressing tool
- 2 Open the adapter for pressing collar and remove it from the pressing collar
- 3 Make sure that the locking pin is in position 3



Result:

The final pressing completes the pressing sequence.

- 4 Pull the release lever towards the pressing collar: The locking pin is released and is located in position 1. The pressing collar is loosened

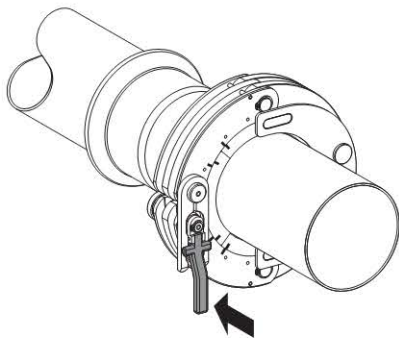

5

Press in the locking pin (1), pull the pressing collar apart and remove it (2)

EN

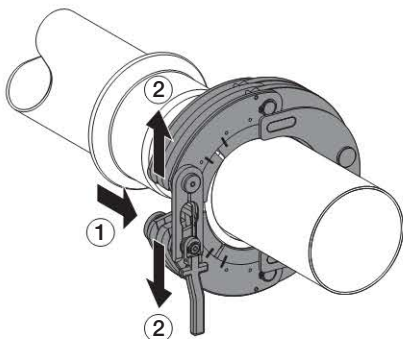

CAUTION



Leaky connection due to failed pressing sequence

- ▶ Ensure that the pressing collar is completely closed after the pressing sequence
- ▶ Have any pressing collars that have not closed completely as well as the adapter for pressing collar and the pressing tool inspected for damage by an authorized repair shop. Replace any connections that have not been pressed correctly (do not attempt corrective pressing)
- ▶ If there are any burrs on the pressfitting after the pressing sequence, have the pressing collar and the adapter for pressing collar inspected by an authorized repair shop

Maintenance intervals



A service sticker on the pressing collar and on the adapter for pressing collar indicates the date when maintenance is next due. The pressing collar along with the adapter for pressing collar and the Geberit pressing tool must always be sent in for maintenance together in the transport case.

To obtain addresses of authorized repair shops, please contact your responsible Geberit sales company or visit www.geberit.com.

Interval	Maintenance work
Regularly (before use, at the start of the working day)	<ul style="list-style-type: none"> • Check the pressing collar and adapter for pressing collar for externally visible defects, particularly for damage, material cracks and other signs of wear. If defects are present, do not continue to use the pressing collar and adapter for pressing collar and either replace it or hand it in to an authorized repair shop • Pressing collar <ul style="list-style-type: none"> – Spray the pressing contour with BRUNOX®Turbo-Spray® or equivalent, leave it on for a brief period, remove dirt and deposits with a cloth – Lubricate joints and locking pin with BRUNOX®Turbo-Spray® or equivalent and move them until they become easy to move. Wipe off any excess lubricant – Spray BRUNOX®Turbo-Spray® or equivalent between the sliding segments and shells and move them until they become easy to move. Wipe off any excess lubricant – Spray the entire pressing collar with a small amount of BRUNOX®Turbo-Spray® or equivalent – Clean electric contacts (only for pressing collars of compatibility [3]) • Adapter for pressing collar <ul style="list-style-type: none"> – Check screw connections and retighten if necessary – Check that the jaw levers can move easily. If necessary, spray the jaw joints with BRUNOX®Turbo-Spray® or equivalent and move them around. Wipe off any excess lubricant – Spray the entire adapter for pressing collar with a small amount of BRUNOX®Turbo-Spray® or equivalent – Clean electric contacts (only for adapters for pressing collar of compatibility [3])
Every year	<ul style="list-style-type: none"> • Have the state of wear of the pressing collar and of the adapter for pressing collar checked by an authorized repair shop



Geberit International AG
CH-8645 Jona

www.geberit.com
dokumentation@geberit.com