



User Manual

Bedienungsanleitung
Mode d'emploi
Istruzioni per l'uso



Target group

This tool may only be used by skilled persons in accordance with EN IEC 82079-1:2012.

Intended use

Geberit Mepla pressing jaws are intended exclusively for professional pressing of Geberit Mepla system pipes with Geberit Mepla press fittings. Geberit recommends using Geberit Mepla pressing jaws in the following pressing tools only:

- Geberit pressing tools that are compatible with Geberit Mepla pressing jaws (indicated by compatibility marks **1** or **2**)
- Pressing tools from other manufacturers approved by Geberit for processing Geberit Mepla

Other pressing tools have not been tested by Geberit in terms of their suitability for the Geberit Mepla pressing system.

WARNING: Risk of injury when used in pressing tools with excessive press capacity

Geberit Mepla pressing jaws are designed to be compatible with the press capacities of Geberit pressing tools and may break if used in pressing tools with a higher press capacity.

In **REMS Power-Press E**, **REMS Power-Press 2000**, **ROLLER'S Uni-Press E** and **ROLLER'S Uni-Press 2000** electromechanical drive machines, insufficient maintenance or incorrect handling can result in increased wear to the installed safety slipping clutch and hence to a considerable increase in the press capacity of these drive machines.

Geberit Mepla pressing jaws are therefore not approved for the drive machines named above.

Basic safety notes

WARNING: Risk of injury caused by flying fragments if used incorrectly or if worn or damaged pressing jaws are used

- Only use the pressing jaws if they are in perfect working order
- Examine the pressing jaws regularly before and after each use for defects, particularly for incipient cracks in the pressing contour and the retaining bracket, and also for other damage. If there are incipient cracks, take the entire pressing jaw out of service immediately and do not use it again
- Do not use a pressing jaw again after it has been used incorrectly or in a way that does not comply with its intended use. Instead, hand it over to an authorised repair shop for testing
- Adhere strictly to maintenance regulations and maintenance intervals for the pressing jaws and pressing tools
- Wear suitable protective equipment (protective goggles etc.)
- Repair work may only be carried out on the pressing jaws by Geberit or an authorised repair shop
- Follow the country-specific safety regulations
- Read all safety notes and instructions. Failure to observe the safety notes and instructions can lead to electric shock, fire and/or serious injuries. Store all safety notes and instructions for the future
- Read through and observe the safety notes enclosed with the pressing tool before commissioning the pressing jaws

EN NOTE

Pressing jaws are wearing parts. Frequent pressing will cause the material to become worn; advanced stages of wear will be indicated by incipient cracks. Pressing jaws that display this kind of wear or are damaged in any other way may break, particularly if they are used incorrectly (e.g. pressing a fitting that is too large, tilting, foreign bodies on the fitting) or in a way that does not comply with their intended use.

General

- Do not continue to use the pressing jaws when they are worn
- Take pressing jaws displaying cracks out of service immediately and do not continue to use them
- Use the transport case for transport and storage, and store the pressing jaws in a dry room
- Observe the safety notes with respect to the cleaning and corrosion-protection agents used

Explanation of symbols

Table 1: Symbols in the instructions









Symbol	Meaning
WARNING 	Refers to a potentially dangerous situation that may cause serious injury or death
CAUTION 	Refers to a potentially dangerous situation that may cause slight or moderate injury or material damage
	Refers to important information
	Indicates that a visual check must be carried out
	Refers to correct usage

Table 2: Symbols on the product

Symbol	Meaning
	Refers to a potentially dangerous situation caused by flying fragments that may cause serious injury or death
	Read the safety notes and operating instructions before commissioning the device
	Service sticker: Indicates the time of the next mandatory maintenance

EN Product description

Structure

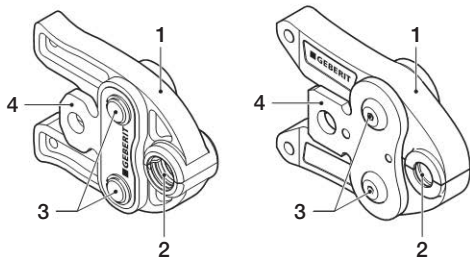

- 1 Jaw lever
- 2 Pressing contour
- 3 Jaw joints
- 4 Retaining bracket

Operation

Inserting the pressing jaw in the pressing tool



The procedure for inserting the pressing jaw depends on the type of pressing tool and is therefore described in the operating instructions of the pressing tool.

Placing the pressing jaw on the pressfitting



WARNING

Risk of injury caused by flying fragments if used incorrectly or if worn or damaged pressing jaws are used

- ▶ Only use the pressing jaw if it is in perfect working order (see the basic safety notes)
- ▶ Make sure that the diameter of the pressfitting matches the diameter of the pressing jaw
- ▶ Do not tilt the pressing jaw on the pressfitting
- ▶ Clean away any dirt, chips or the like between the pressing jaw and the pressfitting
- ▶ If the pressing jaw has been used incorrectly, or in a way that does not comply with its intended use, do not continue to use it and have it inspected by an authorised repair shop
- ▶ Wear suitable protective equipment (protective goggles etc.)

**NOTE**

Pressing jaws are wearing parts. Frequent pressing will cause the material to become worn; advanced stages of wear will be indicated by cracks in the material. Pressing jaws that display this kind of wear or are damaged in any other way may break, particularly if they are used incorrectly (e.g. pressing a fitting that is too large, tilting, foreign bodies on the fitting) or in a way that does not comply with their intended use.

**CAUTION****Danger of crushing by moving parts**

- ▶ Do not place any part of your body or other objects in between the pressing jaws
- ▶ Do not hold the pressing jaw with your hands during the pressing sequence

**CAUTION****Leaking connection due to failed pressing sequence**

- ▶ Ensure the pressing jaw is completely closed after the pressing sequence
- ▶ Have any pressing jaws that have not been closed completely, as well as the pressing tool, inspected for damage by an authorised repair shop
- ▶ Replace any connections that have not been pressed correctly and do not attempt corrective pressing
- ▶ If there are any burrs on the pressfitting after the pressing sequence, have the pressing jaw inspected by an authorised repair shop

-
- 1** To open the pressing jaw, push the ends of the jaw levers together. Position the open pressing jaw on the tool guide rim of the pressfitting (refer to figure A, cover page at the back).

 - 2** Make sure that the pressing jaw is positioned correctly on the tool guide rim of the pressfitting (refer to figure B, cover page at the back).

 - 3** Release both jaw levers.

 - 4** Press the pressfitting; see operating instructions for the pressing tool.

 - 5** After the pressing operation has been completed, make sure that the pressing jaw is completely closed (refer to figure C, cover page at the back).

 - 6** Release the pressing jaw from the pressfitting (refer to figure D, cover page at the back).

Maintenance regulations

**NOTE**

For safety reasons, it is absolutely essential to observe the following maintenance intervals and perform the maintenance work described. The same applies to the mandatory maintenance regulations for the pressing tools. A service sticker on the pressing jaw indicates the time of the next mandatory maintenance.

The pressing jaw must always be sent in for maintenance together with the pressing tool in its transport case.

Repair work may only be carried out on the pressing jaws by Geberit or an authorised repair shop.

For addresses of authorised repair shops, contact your Geberit sales company or visit www.geberit.com.

Interval	Maintenance work
Regularly (before use, at the start of the working day)	<ul style="list-style-type: none">• Remove deposits in the pressing contour• Clean the pressing contour with a cloth soaked in solvent (e.g. methylated spirits)• Spray the pressing contour with BRUNOX® Turbo-Spray® or equivalent• Examine the pressing jaw for externally visible defects; in particular, damage, cracks and other signs of wear. If defects are present, replace the pressing jaw or have it repaired by an authorised repair shop• Spray the entire pressing jaw with BRUNOX® Turbo-Spray® or equivalent• Examine whether the jaw levers can move easily
Annually (after 3000 pressing operations at the latest)	<ul style="list-style-type: none">• Have an authorised repair shop examine the pressing jaw's state of wear

Geberit International AG
Schachenstrasse 77
CH-8645 Jona

T +41 55 221 63 00

F +41 55 221 63 16

documentation@geberit.com

→ www.geberit.com